

KING STREET

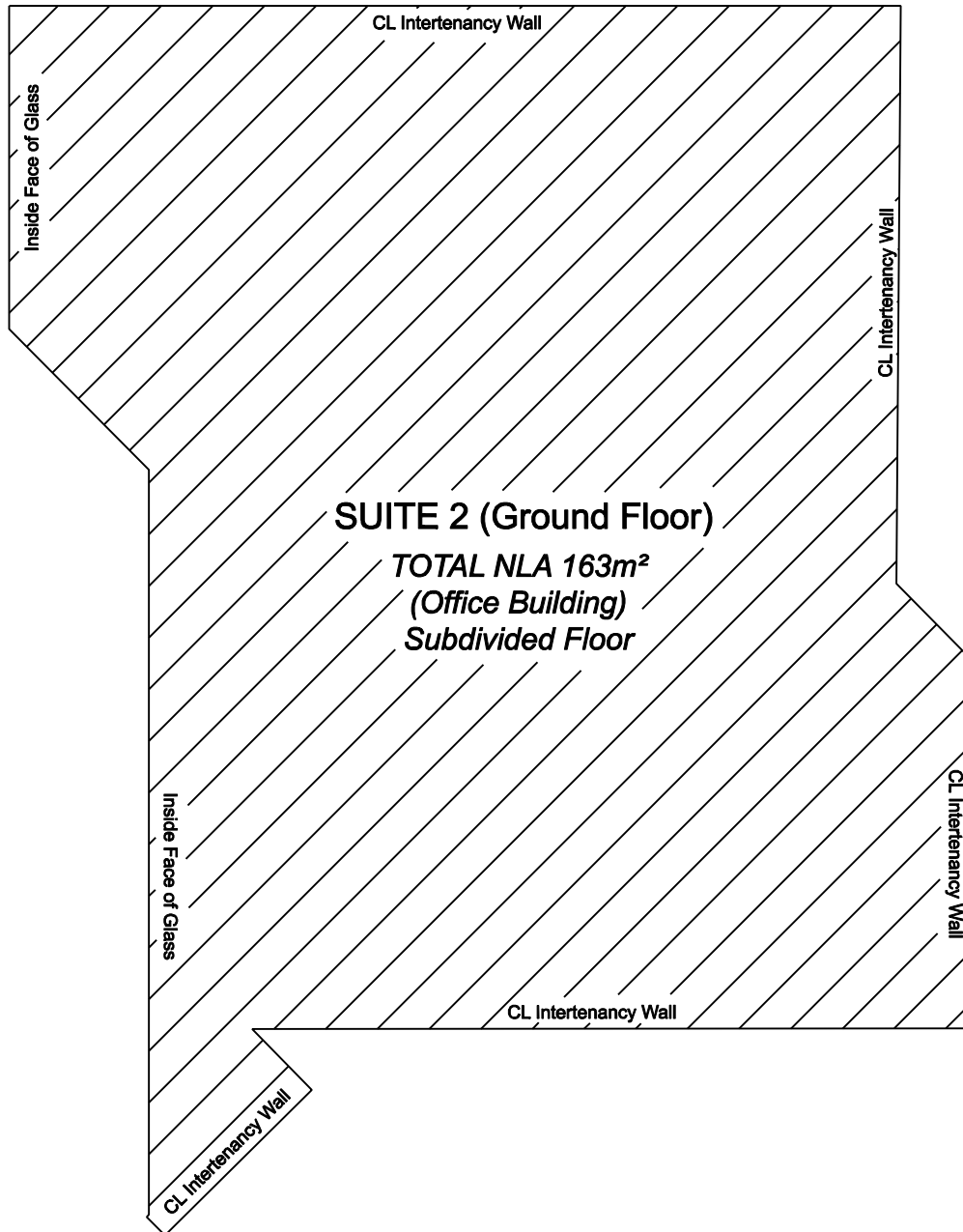

MEASURED IN ACCORDANCE WITH THE PROPERTY COUNCIL OF AUSTRALIA GUIDELINES (1997) FOR NET LETTABLE AREA - SUBDIVIDED FLOOR TENANCY



WHELANS

133 Scarborough Beach Road
PO Box 99 Mount Hawthorn
Western Australia 6016

Surveying
Mapping-Photogrammetry
Urban & Regional Planning
Geographic Information Systems
Cartographic Services & Design

Telephone (08) 9443 1511
Facsimile (08) 9444 3801
whelans@whelans.com.au

benchmark
IN QUALITY
ISO 9001

**NET LETTABLE AREA (OFFICE BUILDING)
SUITE 2 - GROUND FLOOR
The Atruim Building 168 St Georges Tce PERTH**

DATE: 10.12.2003	WORK DIR:K:\CARTO\8082	SURVEY DATE: 10.12.03	HORIZ DATUM: Local
JOB No. 08082	DGN FILE: bomagroundfloor-s2-nla.dgn	SURVEYOR: P.G.J.	VERT. DATUM: N/A
SCALE: 1:100 (A4)	DRAWN: R.M.	CHECKED: P.G.J.	PLAN No.: FP-8082-032-REV1

This plan must not be reproduced without the permission of WHELANS.
All Cadastral dimensions are subject to survey.

LICENSED SURVEYOR: DATE:

CLIENT: LLOYD COLLINS

SHEET 1 OF 1